

# GM 5-9

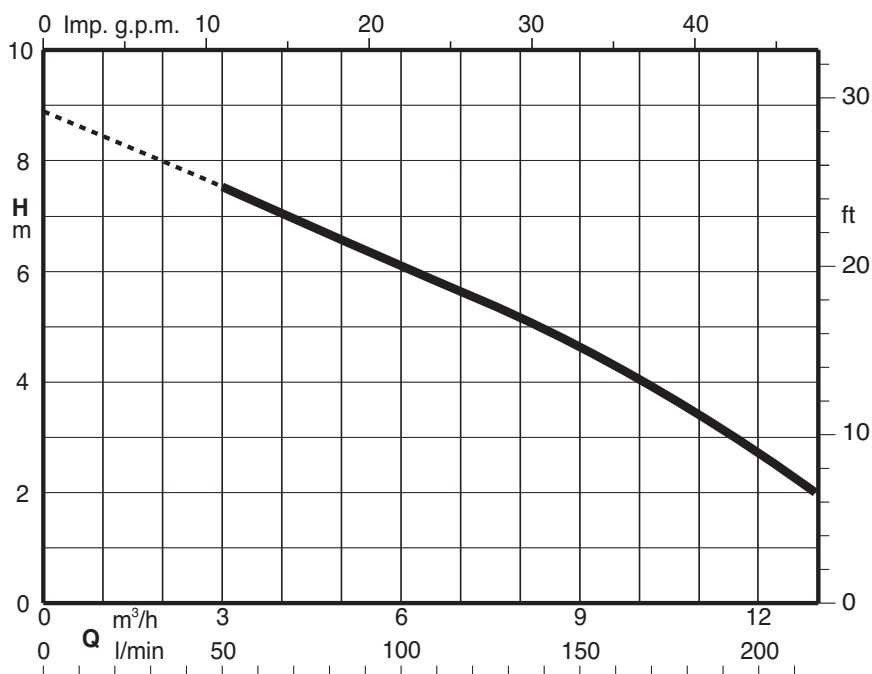

Coverage chart  $n \approx 2800$  rpm



## Submersible drainage pump

# GM 5-9



## Construction

Submersible drainage pump constructed with composite polymers developed especially for this product.

Double shaft seal with oil chamber.

Small dimensions and great performance, for use in a wide variety of applications, for flow rates up to 217 litres per minute.

With float switch for automatic start and stop.

## Applications

For clean water with suspended solids up to a diameter of 5 mm.

For draining flooded rooms or tanks.

Extraction of water from ponds, flowing water or pits for collection of rain water. For irrigation.

## Operating conditions

Maximum liquid temperature for prolonged use: 35 °C (with immersed motor).

Immersion depth: 5 m max.

## Motor

2-pole induction motor, 50 Hz ( $n \approx 2800$  1/min).

Single-phase 230 V  $\pm 10\%$ , with thermal protector.

Incorporated capacitor

Cable H05RN-F, 3G0,75 mm<sup>2</sup>: with plug, length 10 m, 245IEC57, according to EN 60335-2-41 for pumps up to 10 kg.

Insulation class F.

Protection IP 68.

## Materials

Components	Materials
Pump casing	PP+GF30
Impeller	PA66+GF30
motor jacket	Chrome-nickel steel 1.4301 EN 10088 (AISI 304)
Pump jacket	PP+GF30
Filter	PP+GF30
Handle	PP+GF30
Shaft	45#nickel
Mechanical seal	Graphite/Ceramic/NBR
Seal lubrication oil	N7 machine oil

## Performance $n \approx 2800$ rpm

### Single-phase

Model	230V A	P2		P1 kW	Q = Flow							
		kW	HP		m <sup>3</sup> /h l/min	0	1,2 20	3 50	6 100	9 150	12 200	13 217
GM 5-9	2,4	0,33	0,45	0,55		8,9	8,2	7,6	6,1	4,7	2,8	2

H (m) = Total head

**P1:** Maximum power input.

**P2:** Rated motor power output.

**H:** Total head in m

## Dimensions and weights

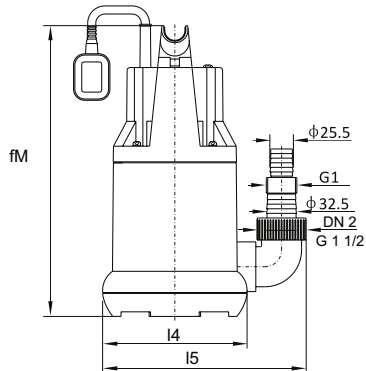

TYPE	DN2	fM	mm				kg Weight
			I4	I5	Lmax	Lmin	
GM 5-9	G 1 1/2	316	157	222	340	120	4.7

## Examples of installations

